



StationProtect™ 2

Multi-Threat Air Decontamination System

INSTRUCTION FOR INSTALLATION, OPERATION, AND MAINTENANCE

⚠ DANGER

Understand manual before use. Operation of this device without understanding the manual and receiving proper training is a misuse of this equipment. Obtain safety information at tft.com/serial-number.

This instruction manual is intended to familiarize installers, end users, and maintenance personnel with the operation, servicing, and safety procedures associated with this product. This manual should be kept available to all operating and maintenance personnel.



TASK FORCE TIPS LLC
MADE IN USA · tft.com

3701 Innovation Way, Valparaiso, IN 46383-9327 USA
800-348-2686 · 219-462-6161 · Fax 219-464-7155

TABLE OF CONTENTS

- 1.0 MEANING OF SAFETY SIGNAL WORDS
- 2.0 GENERAL INFORMATION
 - 2.1 PART IDENTIFICATION
 - 2.2 SPECIFICATIONS
- 3.0 INSTALLATION
 - 3.1 UNPACKING THE UNIT
 - 3.2 POWER CABLE AND PLUG FOR NON-US UNITS
 - 3.3 CARTRIDGE INSTALLATION
 - 3.4 POSITIONING THE UNIT
 - 3.5 GENERAL SAFETY
- 4.0 OPERATION
- 5.0 WARRANTY
- 6.0 MAINTENANCE
 - 6.1 CARTRIDGE LIFE CYCLE
 - 6.2 CHANGING THE CARTRIDGES
 - 6.3 DISPOSING OF CARTRIDGES
- 7.0 REPAIR
- 8.0 OPERATION AND INSPECTION CHECKLIST

DANGER

PERSONAL RESPONSIBILITY CODE

The member companies of FEMSA that provide emergency response equipment and services want responders to know and understand the following:

1. **Firefighting and Emergency Response are inherently dangerous activities** requiring proper training in their hazards and the use of extreme caution at all times.
2. **IT IS YOUR RESPONSIBILITY** to read and understand any user's instructions, including purpose and limitations, provided with any piece of equipment you may be called on to use.
3. **IT IS YOUR RESPONSIBILITY** to know that you have been properly trained in Firefighting and/or Emergency Response and in the use, precautions, and care of any equipment you may be called upon to use.
4. **IT IS YOUR RESPONSIBILITY** to be in proper physical condition and to maintain the personal skill level required to operate any equipment you may be called upon to use.
5. **IT IS YOUR RESPONSIBILITY** to know that your equipment is in operable condition and has been maintained in accordance with the manufacturer's instructions.
6. Failure to follow these guidelines may result in death, burns or other severe injury.

Fire and Emergency Manufacturers and Service Association, Inc.
PO Box 147, Lynnfield, MA 01940 • www.FEMSA.org

© 2020 FEMSA. All Rights Reserved.

1.0 MEANING OF SAFETY SIGNAL WORDS

A safety related message is identified by a safety alert symbol and a signal word to indicate the level of risk involved with a particular hazard. Per ANSI Z535.6, the definitions of the four signal words are as follows:

- DANGER** indicates a hazardous situation which, if not avoided, will result in death or serious injury.
- WARNING** indicates a hazardous situation which, if not avoided, could result in death or serious injury.
- CAUTION** indicates a potentially hazardous situation which, if not avoided, could result in minor or moderate injury.
- NOTICE** is used to address practices not related to physical injury.

2.0 GENERAL INFORMATION

The StationProtect quickly and effectively removes many harmful airborne contaminants including particulates, aerosols, VOCs, and mold spores. StationProtect's quiet, portable design is easy to use, low maintenance, and works with standard electrical outlets.

2.1 PART IDENTIFICATION

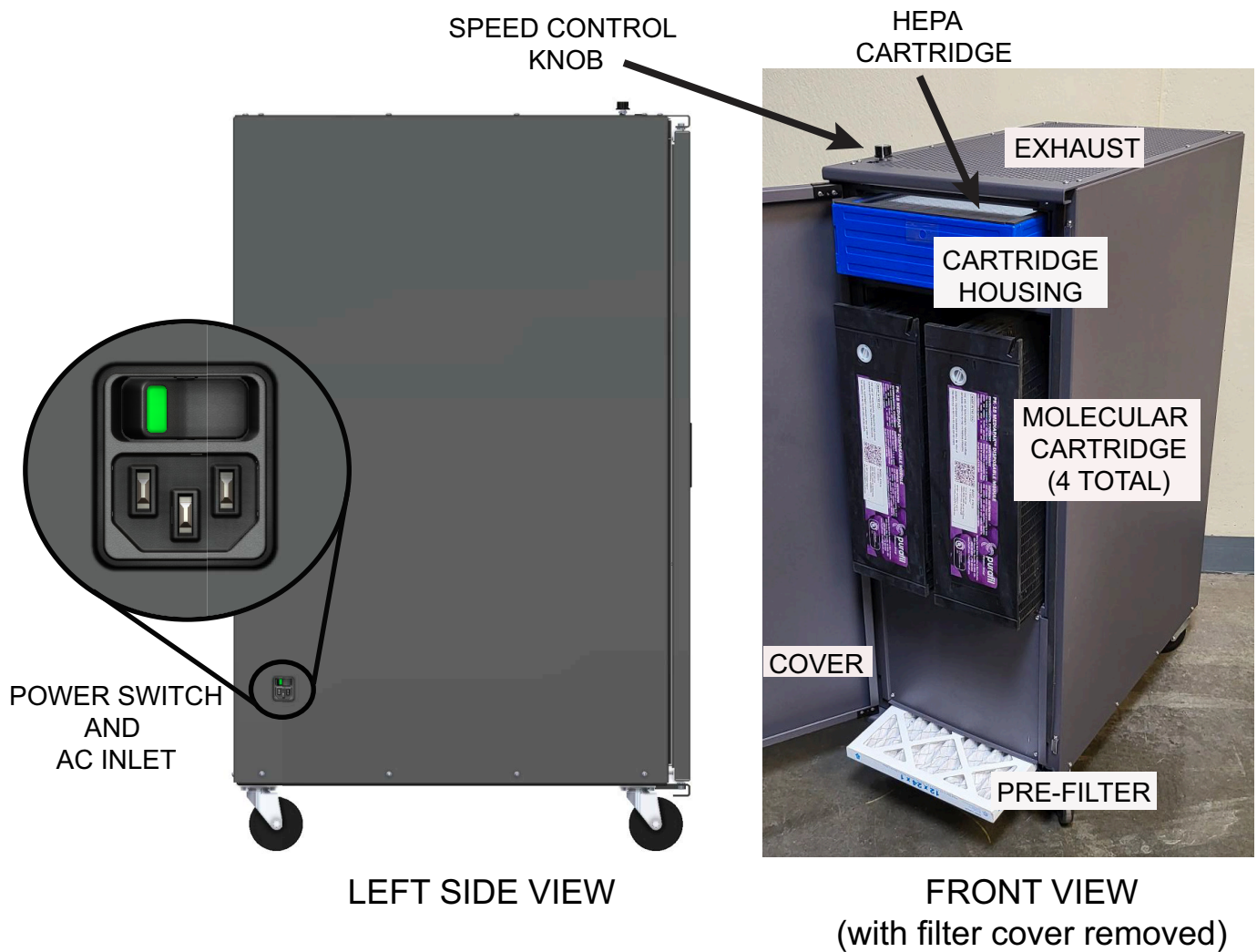

Figure 2.1

2.2 SPECIFICATIONS

Dimensions inch (mm)	15 x 25 x 42 (381 x 635 x 1067)
Weight	165 lbs
Decontamination Protection	Particulates, VOCs, Aerosols
Flow Rate	755 CFM (nominal)
Operating Pressure	1 Atmosphere
Voltage	110VAC US / 220VAC EU
Sound (fan running)	<65 dB (nominal)

Table 2.2

3.0 INSTALLATION

3.1 UNPACKING THE UNIT

Upon receipt of your StationProtect Multi-Threat Air Decontamination System:

1. Remove the unit from its packaging and inspect for damage. Immediately report any damage to the carrier.
2. Read and understand all instructions and safety information.
3. Completely unravel the power cord and inspect for damage. Do not use if power cord is damaged.
4. Place the unit in the upright position with the casters on the floor.

3.2 POWER CABLE AND PLUG FOR NON-US UNITS

Units for use with non-US power ship without power cable power cable. **The user will provide the appropriate power plug to meet the requirements for their installation. The unit uses a C13 socket.**



Electric shock can cause injury or death. For units used with non-US power, it is required that a licensed electrician install the power plug to the power cable.

3.3 CARTRIDGE INSTALLATION

The cartridges are shipped separate from the unit with a protective wrap covering. Just prior to starting the unit, remove the protective wrap and install the cartridges following the instructions ([see section 6.2](#)).

NOTICE

Protective plastic wrap should not be removed from the cartridges until ready for installation as the effectiveness of the molecular material starts degrading after exposure to ambient air. Failure to remove the protective wrap from the cartridge prior to installation will cause the unit to overheat and turn off due to lack of air flow.

3.4 POSITIONING THE UNIT

Place the StationProtect on a firm, flat, dry, level surface. Position the unit at least 4 inches from any wall, furniture, or other items that could obstruct the vents. The unit is intended for indoor use only.



This device is not rated as ignition proof, explosion proof, or intrinsically safe. Use only in locations with adequate ventilation and no hazard of flammable vapor buildup.

To reduce the risk of injury or damage to the unit due to ignition or explosion, keep the unit away from:

- Heated surfaces
- Open flames
- Combustible gasses



Using electrical devices in the presence of water increases the risk of injury or damage due to electrical shock. To reduce the risk of electrical shock:

- Keep the unit away from water or other liquids.
- Do not use an extension cord.

NOTICE

To ensure proper air flow and function of the StationProtect:

- The unit must be in the upright position (casters on the floor).
- Choose a location where there is at least 4 inches of free space around all air ducts.
- Keep air ducts free from obstruction by loose items such as clothing, paper, dirt, or equipment.
- Do not place heavy objects on the unit.
- Do not use the unit as a shelf.
- Do not hang objects from the unit.

3.5 GENERAL SAFETY

CAUTION

The electrical cord can be a tripping hazard. To avoid injury or equipment damage:

- Position the power cord where it cannot be stepped on or tripped over.
- Do not run power cord under carpet or cover with throw rugs.

NOTICE

Always turn the power switch to the off (O) position and unplug from the wall before moving the unit, changing the filter or whenever it is not in use.

Be sure to pull the plug and not the cord when disconnecting from the outlet.

NOTICE

Foreign objects in the unit can cause damage. Do not drop, insert or allow any objects to enter into any opening of the unit. If this occurs, immediately turn off and unplug the device.

- Call a customer service representative.
- Do not attempt to service the unit. Doing so will void the warranty.
- Do not operate the unit if it malfunctions or becomes damaged in any way.

4.0 OPERATION

With the unit properly in position:

1. Completely unravel the power cord.
2. Make sure the speed control knob is in the OFF position.
3. Plug the power cord into an appropriate wall outlet (USA-120V/60Hz, EU-220V/50-60Hz).
4. StationProtect features a variable position rotary switch with an OFF position, and infinitely adjustable speeds from low to high. When first turning on the StationProtect, set to the highest setting and let it run for one hour. After one hour, turn speed control switch to desired setting.
5. StationProtect is designed to run 24/7. This ensures optimal cartridge performance and improves air quality on a continuous basis..

Regular cartridge replacement ensures optimal air decontamination, ([see section 6.1](#)) for cartridge life cycle and ([see section 6.2](#)) for replacement instructions.

5.0 WARRANTY

Task Force Tips LLC, 3701 Innovation Way, Valparaiso, Indiana 46383-9327 USA (“TFT”) warrants to the original purchaser of its products (“equipment”), and to anyone to whom it is transferred, that the equipment shall be free from defects in material and workmanship during the two (2) year period from the date of purchase. TFT’s obligation under this warranty is specifically limited to replacing or repairing the equipment (or its parts) which are shown by TFT’s examination to be in a defective condition attributable to TFT. To qualify for this limited warranty, the claimant must return the equipment to TFT, at 3701 Innovation Way, Valparaiso, Indiana 46383-9327 USA, within a reasonable time after discovery of the defect. TFT will examine the equipment. If TFT determines that there is a defect attributable to it, TFT will correct the problem within a reasonable time. If the equipment is covered by this limited warranty, TFT will assume the expenses of repair.

If any defect attributable to TFT under this limited warranty cannot be reasonably cured by repair or replacement, TFT may elect to refund the purchase price of the equipment, less reasonable depreciation, in complete discharge of its obligations under this limited warranty. If TFT makes this election, claimant shall return the equipment to TFT free and clear of any liens and encumbrances.

This is a limited warranty. The original purchaser of the equipment, any person to whom it is transferred, and any person who is an intended or unintended beneficiary of the equipment, shall not be entitled to recover from TFT any consequential or incidental damages for injury to person and/or property resulting from any defective equipment manufactured or assembled by TFT.

It is agreed and understood that the price stated for the equipment is in part consideration for limiting TFT’s liability. Some states do not allow the exclusion or limitation of incidental or consequential damages, so the above may not apply to you.

TFT shall have no obligation under this limited warranty if the equipment is, or has been, misused or neglected (including failure to provide reasonable maintenance) or if there have been accidents to the equipment or if it has been repaired or altered by someone else.

THIS IS A LIMITED EXPRESS WARRANTY ONLY. TFT EXPRESSLY DISCLAIMS WITH RESPECT TO THE EQUIPMENT ALL IMPLIED WARRANTIES OF MERCHANTABILITY AND ALL IMPLIED WARRANTIES OF FITNESS FOR A PARTICULAR PURPOSE. THERE IS NO WARRANTY OF ANY NATURE MADE BY TFT BEYOND THAT STATED IN THIS DOCUMENT.

This limited warranty gives you specific legal rights, and you may also have other rights which vary from state to state.

6.0 MAINTENANCE

Your StationProtect is designed to require very little maintenance. To remove the dust buildup on the air intake, vacuum the exterior of the unit using the brush attachment of your vacuum cleaner. To clean the other surfaces, wipe with a soft dampened cloth. Avoid the use of any solvents as this may damage the finish of the unit.

6.1 CARTRIDGE LIFE CYCLE

The cartridges in the StationProtect have varying life cycles based on their function. A complete cartridge kit (TFT Part# CC-605) contains the necessary cartridges for 1 year of service in a typical 24/7 operation.

WARNING Cartridge changes at the specified intervals is critical to providing protection to personnel. The cartridge media has a time-based effective life after the protective wrap is removed. Schedule regular maintenance tasks or note change dates on the unit to ensure cartridges are changed regularly.

Filter Type	Quantity	Function	Service Schedule
Pre-filter	4	Traps dust, pollen and other large particulate matter.	Quarterly (1 every 3 months)
HEPA Cartridge	1	Captures PM0.3, PM2.5 and other particulates.	Annually (1 per year)
Molecular Cartridge	4	Patented molecular media removes aerosols carrying viruses from the air, safely oxidizing the molecules, while removing toxic and harmful gases.	Annually (4 cartridges at 1 time per year)

NOTICE

All replacement parts must be obtained from Task Force Tips and its approved dealer network to assure proper performance and operation of the device.

6.2 CHANGING THE CARTRIDGES

NOTICE

Protective plastic wrap should not be removed from the cartridges until ready for installation as the effectiveness of the molecular material starts degrading after exposure to ambient air. Failure to remove the protective wrap from the cartridge prior to installation will cause the unit to overheat and turn off due to lack of air flow.

1. Pre-filter (every 3 months)

1. Open the front cover of the unit.
2. Slide the old filter out of the unit.
3. Install the new filter with the flow arrows (on the side of the filter) pointing up.
4. Close the front cover of the unit.

2. HEPA Cartridge (once per year)

1. Open the front cover of the unit.
2. Remove filter cover (6 Phillips screws, 3 per side).
3. Slide the cartridge housing out.
4. Lift the old cartridge out of the housing.
5. Place the new cartridge in the housing with the flow arrows (on the side of the cartridge) pointing up.
6. Slide the cartridge housing back.
7. Reinstall filter cover.
8. Close the front cover of the unit.

3. Molecular Cartridge (4 cartridges, once per year)

1. Open the front cover of the unit.
2. Remove filter cover (6 Phillips screws, 3 per side).
3. Remove all 4 cartridges (2 per side).
4. Install 4 new cartridges (2 per side).
5. Reinstall filter cover.
6. Close the front cover of the unit.

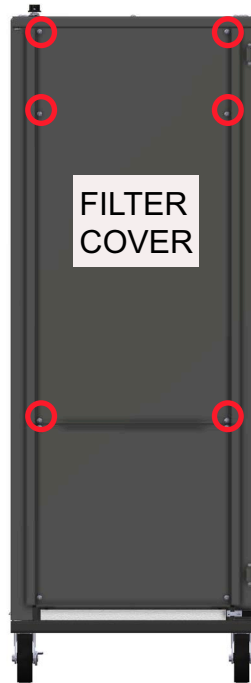

6.3 DISPOSING OF CARTRIDGES

The cartridge material is designed to neutralize the toxins captured in the cartridges, rendering them no longer hazardous. Used cartridges can be disposed of in normal refuse. Avoid the use of any solvents as this may damage the finish of the unit.

7.0 REPAIR

Factory service is available. Factory serviced equipment is repaired by experienced technicians, tested to original specifications, and promptly returned. Call TFT service department at 1-800-348-2686 to troubleshoot and if needed, directions for return.



Any alterations to the product or its markings could diminish safety and constitutes a misuse of this product.

8.0 OPERATION AND INSPECTION CHECKLIST

BEFORE EACH USE and BEFORE BEING PLACED BACK IN SERVICE, the StationProtect must be inspected to this checklist:

1. There is no obvious damage such as missing, broken or loose parts, damaged labels, etc.
2. All air ducts are clean and unobstructed.
3. The area around the device is clean and free of loose debris.
4. There are no objects sitting on top of the device.
5. All markings are legible.



Equipment failing any part of the checklist is unsafe for use and must have the problem corrected before use or being placed back into service. Operating equipment that has failed the checklist is a misuse of this equipment.